

HEATING  
VENTILATION  
AIR CON  
WATER

**WRAS**  
APPROVED  
PRODUCT

FUTURE VALVE TECHNOLOGY

# Maximum Performance DZR Ball Valves

New

HNH Fig 100 (Threaded) / HNH Fig 100C (Compression)



Dezincification resistant  
WRAS Approved  
Main Joint O-Ring Seal (Threaded)  
Installation tags  
Multiple operating options

 **Hattersley**

DELTA ROAD, ST HELENS, WA9 2ED  
HOME SALES: +44 (0)1744 458670  
EXPORT SALES: +44 (0)1744 458671  
TECHNICAL HELPLINE: 0845 604 1790  
FAX: +44 (0)1744 26912  
EMAIL: [uksales@hattersley.com](mailto:uksales@hattersley.com)  
EMAIL: [export@hattersley.com](mailto:export@hattersley.com)  
[www.hattersley.com](http://www.hattersley.com)



- WRAS - Approved for use on Potable Water
- Designed and manufactured under quality management systems in accordance with BS EN ISO 9001:2008

H\_DZR\_06\_2009

**CRANE** BUILDING SERVICES & UTILITIES

[www.cranesbu.com](http://www.cranesbu.com)

 **Hattersley**

Quality reliability & service assured



An internationally respected market leader in ball valve technology for over 100 years, the Hattersley brand has become synonymous with quality, reliability and excellent service. The company's latest offering is the next generation of DZR ball valves for the water, heating, ventilation and air conditioning markets.



# DZR Ball Valves - HNH Fig 100

## Maximum Performance Benefits

Hattersley's 'new generation' ball valves are light, compact and easy to install and operate.

Design updates include features that improve leak protection and resistance to damage during installation.

The newly designed Hattersley DZR ball valves are fully approved for potable water systems by the Water Regulatory Advisory Scheme (WRAS).

Available from 1/4" to 2" threaded fittings and 15mm to 54mm compression diameters. Customers can choose from multiple handle options - lever, extended stem, 'T' handle and lockshield, according to individual specification.

### Improved installation instructions

To aid installation there are new installation tags which are water and tear resistant. They show the correct way of installing threaded or compression valves.

ASSEMBLE PIPE INTO VALVE TO HAND TIGHT THEN TIGHTEN BY NUMBER OF TURNS SHOWN BELOW (UP TO 1 ADDITIONAL TURN IS PERMITTED FOR ALIGNMENT)

VALVE SIZE	TURNS	VALVE SIZE	TURNS
1/4	1.5	1	1.5
3/8	1.5	1 1/4	1.5
1/2	1.5	1 1/2	1.5
3/4	1.5	2	2

Threaded tag used as example.



Multiple operating handle options (Clockwise from top right), quarter turn lever, extended stem lever, "T" handle & lockshield.



Secondary O ring seal, for additional leakage protection, aids resistance to site installation damage.



Loctite 648 is used on the main joint threads to give more strength and resistance to installation damage.



Available in different taper thread options - BS EN 10226-2 or ANSI B1.20.1.

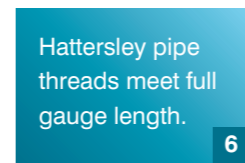
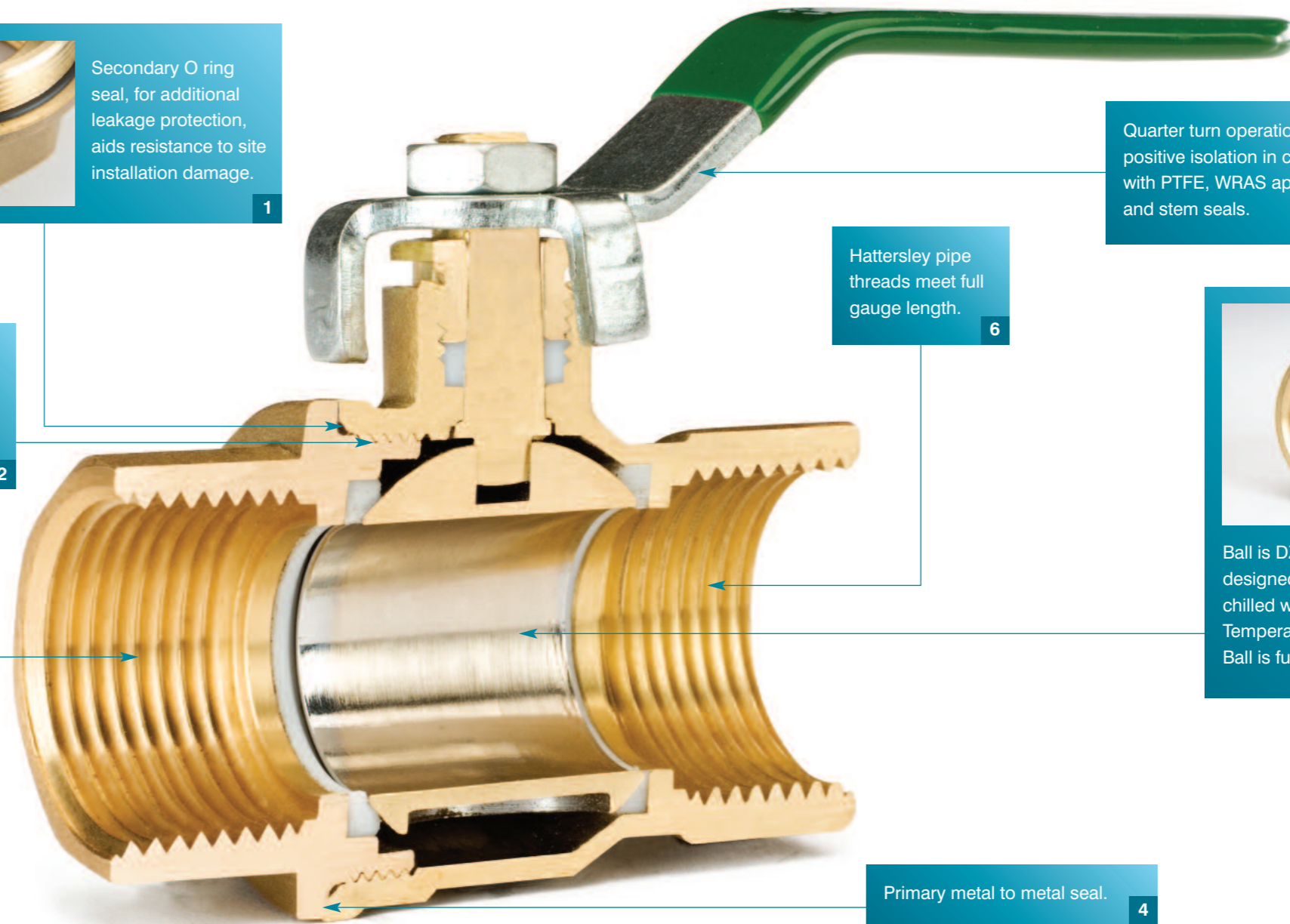

Hattersley pipe threads meet full gauge length.

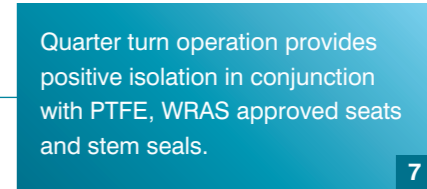

Quarter turn operation provides positive isolation in conjunction with PTFE, WRAS approved seats and stem seals.



Ball is DZR brass chrome plated, designed for a long life. Ideal for chilled water applications. Temperature range is -10 to 120°C. Ball is full bore.



Primary metal to metal seal.

THE CUT AWAY SHOWN IS THE THREADED VERSION

# 100 | 100EXT Extended Stem



## MATERIALS

Name	Material	Quantity
Hex-Nut	Steel Plated	1
Lever	Steel Dacromet Plated	1
Sleeve	Green PVC	1
Packing Nut	Brass CW617N	1
Packing Gland	PTFE WRAS Approved	1
Body	DZR Brass CW602N	1
Seat	PTFE WRAS Approved	2
Ball	DZR Brass CW602N Chrome Plated	1
O-Ring	Rubber EPDM WRAS Approved	1
Bonnet	DZR Brass CW602N	1
Stem	DZR Brass CW602N	1
Extension Stem Outer	Aluminium	1
Extension Stem Inner	Steel Plated	1

100

100EXT

## DIMENSIONS AND WEIGHTS

Size	Weight (g)	Weight (g)	L (mm)	L1 (mm)	L2 (mm)	H (mm)	H (mm)
	100	100EXT	100		100	100	100EXT
1/4"	152	-	45.3	12	89	41	-
3/8"	136	-	45.3	12	89	41	-
1/2"	205	242	58.5	15.5	98.5	48	103
3/4"	302	339	67	17	98.5	51	107
1"	511	560	80.5	21	125	62	116
1 1/4"	890	939.5	94.5	23	140	77.5	129
1 1/2"	1292	1346	102.5	23	140	83	135
2"	2238	2230	122.5	26.5	165	95.5	150

Models in white to follow shortly

## PRESSURE / TEMPERATURE RATINGS THREADED

Temperature °C	-10-100	120
Pressure (bar)	25	21.8

Intermediate pressure ratings shall be determined by interpolation

## DIMENSIONAL DRAWING

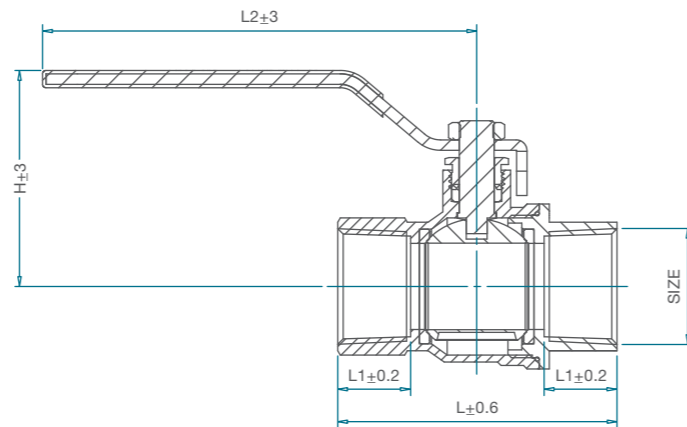

# 100T T-Handle | 100LS Lockshield



## MATERIALS

Name	Material	Quantity
Hex-Nut	Steel Plated	1
T-Handle	Aluminium AL-46100 Maroon	1
Packing Nut	Brass CW617N	1
Packing Gland	PTFE WRAS Approved	1
Body	DZR Brass CW602N	1
Seat	PTFE WRAS Approved	2
Ball	DZR Brass CW602N Chrome Plated	1
O-Ring	Rubber EPDM WRAS Approved	1
Bonnet	DZR Brass CW602N	1
Stem	DZR Brass CW602N	1
Lockshield	Brass CW617N	1
Lockshield Cover	Polypropelene Green	1

100T

100LS

## DIMENSIONS AND WEIGHTS

Size	Weight (g)	Weight (g)	L (mm)	L1 (mm)	L2 (mm)	H (mm)	H (mm)
	100T	100LS			100T	100T	100LS
1/2"	180	213	58.5	15.5	50	39.3	43.8
3/4"	277	310	67	17	50	42.8	46.8
1"	470	516	80.5	21	55	53.7	59.2
1 1/4"	817	879	94.5	23	82	60.5	68
1 1/2"	1224	1286	102.5	23	82	66.3	73.8
2"	2055	2128	122.5	26.5	110	79.5	85.5

Models in white to follow shortly

## PRESSURE / TEMPERATURE RATINGS THREADED

Temperature °C	-10-100	120
Pressure (bar)	25	21.8

Intermediate pressure ratings shall be determined by interpolation

## DIMENSIONAL DRAWING

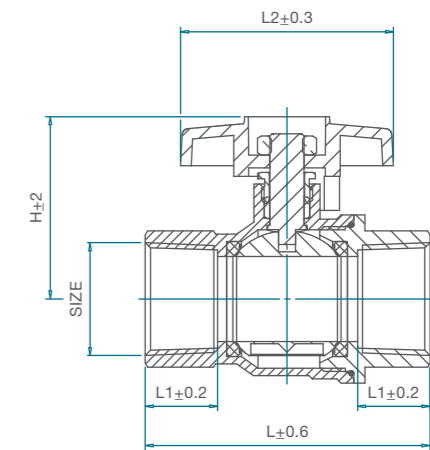

Pressure Rating: PN25 • UK End Connection: BS EN 10226-2 FORMERLY BS21 Taper  
US End Connection: ANSI B1.20.1 • Operator: Lever

Specification: Quarter Turn | PTFE seats and stem seal | WRAS listed.

Pressure Rating: PN25 • UK End Connection: BS EN 10226-2 FORMERLY BS21 Taper  
US End Connection: ANSI B1.20.1 • Operator: T-Handle/Spanner/Socket

Specification: Quarter Turn | PTFE seats and stem seal | WRAS listed.

# 100C | 100CEXT Extended Stem



## MATERIALS

Name	Material	Quantity
Hex-Nut	Steel Plated	1
Lever	Steel Dacromet Plated	1
Handle Sleeve	Maroon PVC	1
Packing Nut	Brass CW617N	1
Packing Gland	PTFE WRAS Approved	1
Body	DZR Brass CW602N	1
Seat	PTFE WRAS Approved	2
Ball	DZR Brass CW602N Chrome Plated	1
Bonnet	DZR Brass CW602N	1
Compression Olive	Brass CW507L	2
Compression Nut	DZR Brass CW602N	2
Stem	DZR Brass CW602N	1
Extension Stem Outer	Aluminium	1
Extension Stem Inner	Steel Plated	1

100C

100CEXT

## DIMENSIONS AND WEIGHTS

Size	Weight (g) C	Weight (g) CEXT	L (mm) C	L2 (mm) C	H (mm) C	H (mm) CEXT
15mm	212	249	66.5	98.5	48	103
22mm	368	405	80	98.5	51	107
28mm	608	657	92.5	125	62	116
35mm	1007	160	104.5	140	77.5	129
42mm	1549	1580	122	140	83	135
54mm	2538	2605	141	165	95.5	150

Models in white to follow shortly

## DIMENSIONAL DRAWING

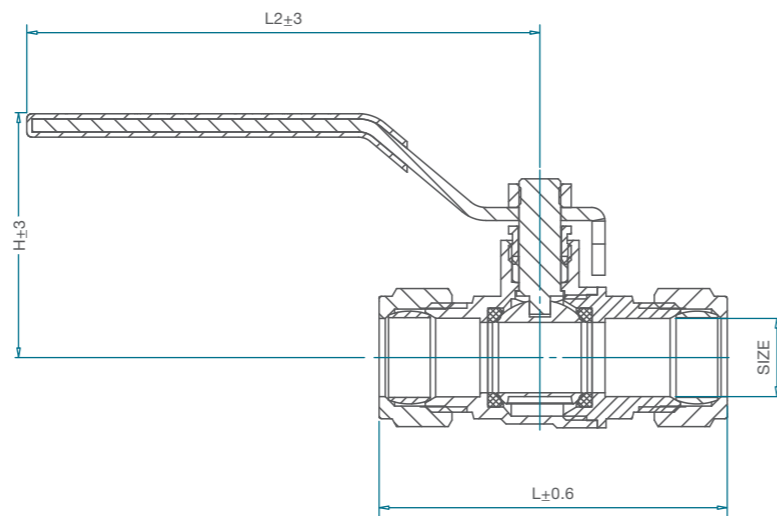

## PRESSURE / TEMPERATURE RATINGS COMPRESSION

Temperature °C	-10-30	40	50	65	80	90	100	110	120
Pressure (bar)	16	14.3	12.6	10	8.7	7.8	6.9	6	5

Intermediate pressure ratings shall be determined by interpolation

Pressure Rating: PN16 • UK End Connection: Compression Ends to BS EN 1254-2 • Operator: Lever  
 Specification: Quarter Turn | PTFE seats and stem seal | WRAS listed.

# 100CT T-Handle | 100CLS Lockshield



## MATERIALS

Name	Material	Quantity
Hex-Nut	Steel Plated	1
T-Handle	Aluminium AL-46100 Green	1
Packing Nut	Brass CW617N	1
Packing Gland	PTFE WRAS Approved	1
Body	DZR Brass CW602N	1
Seat	PTFE WRAS Approved	2
Ball	DZR Brass CW602N Chrome Plated	1
Bonnet	DZR Brass CW602N	1
Compression Olive	Brass CW507L	2
Compression Nut	DZR Brass CW602N	2
Stem	DZR Brass CW602N	1
Lockshield	Brass CW617N	1
Lockshield Cover	Polypropelene Green	1

100CT

100CLS

## DIMENSIONS AND WEIGHTS

Size	Weight (g) CT	Weight (g) CLS	L (mm) CT	L2 (mm) CLS	H (mm) CT	H (mm) CLS
15mm	187	220	66.8	50	38.5	42.5
22mm	343	376	80	50	43	47
28mm	567	614	92.5	55	54	59.5
35mm	976.5	1039	106	82	60.5	67.5
42mm	1487	1549	123.5	82	66.5	73.5
54mm	2363.5	2437	141.2	110	80.5	87.5

Models in white to follow shortly

## DIMENSIONAL DRAWING

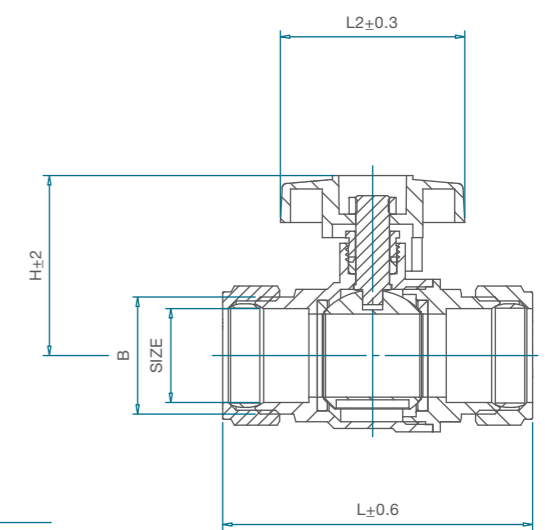

## PRESSURE / TEMPERATURE RATINGS COMPRESSION

Temperature °C	-10-30	40	50	65	80	90	100	110	120
Pressure (bar)	16	14.3	12.6	10	8.7	7.8	6.9	6	5

Intermediate pressure ratings shall be determined by interpolation

Pressure Rating: PN16 • UK End Connection: Compression Ends to BS EN 1254-2 • Operator: T-Handle/Spanner/Socket  
 Specification: Quarter Turn | PTFE seats and stem seal | WRAS listed.