

Fig. 249 & 249C Brass - Single & Double Check (Fig. 249C Chromium Plated) Check Valves



FEATURES AND BENEFITS

- WRAS approved for use with potable water
- Compression ends for use with half hard R250 copper pipe
- Single, double and chromium plated options available

MATERIAL SPECIFICATION

Component	Material	Specification BS EN
Body	DZR Brass	12165 CW602N



DIMENSIONAL DRAWINGS

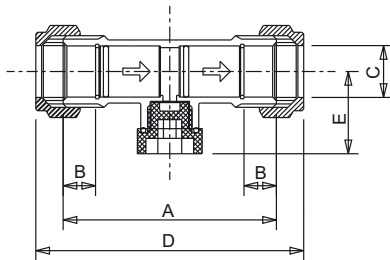

Fig. 249 & 249C

PRESSURE/ TEMPERATURE RATING

16 bar from -10 to 85°C

TEST PRESSURES (HYDRAULIC)

Body: 24 bar
Seat: 17.6 bar

SPECIFICATION

Fig. No. 249

Double Check - 15mm, 22mm, 28mm

Fig. No. 249C

Double Check chromium plated - 15mm

Manufactured to BS 6282.

WRAS approved PN16 85°C.

Application: Water.

End Connection: Compression.

Back Flow Prevention Device category:

Single check - Class 2 as per Water Supply.

Contamination Risks (water fittings)

Regulations 1999.

Double check - Class 3 as per Water Supply.

Contamination Risks (water fittings)

Regulations 1999.

DIMENSIONS AND WEIGHTS

Nom Size	mm	15	22	28	15
		Fig. 249	Fig. 249	Fig. 249	Fig. 249C
A	mm	61.4	74.6	88.6	61.4
B	mm	9.5	10.5	12.5	9.5
C	mm	15.2	22.2	28.25	15.2
D	mm	78.5	91.4	106.3	78.5
E	mm	24.5	27.5	30.5	24.5
Weight (approx)	kg	0.116	0.212	0.360	0.116

Every effort has been made to ensure that the information contained in this publication is accurate at the time of publishing. Hattersley Ltd assumes no responsibility or liability for typographical errors or omissions or for any misinterpretation of the information within the publication and reserves the right to change without notice.